



## Underground Manifold Chambers

### Features and Benefits

- Designed for heat pump applications
- Ease of installation
- Water resistant
- Removable lid
- Driveway rated (35kN)
- Flow measurement / control option
- Fill / bleed ports
- Frost protection
- 

### Product Description

The underground manifold chambers are pre-fabricated and designed specifically for use with ground source heat pump installations.

They provide security and a central position to connect the heat pump's ground array pipes together.

Manufactured from tough, resistant polyethylene they are available in a range of sizes and with differing numbers of inlets and outlets with control valves, flow meters and fill and bleed ports.

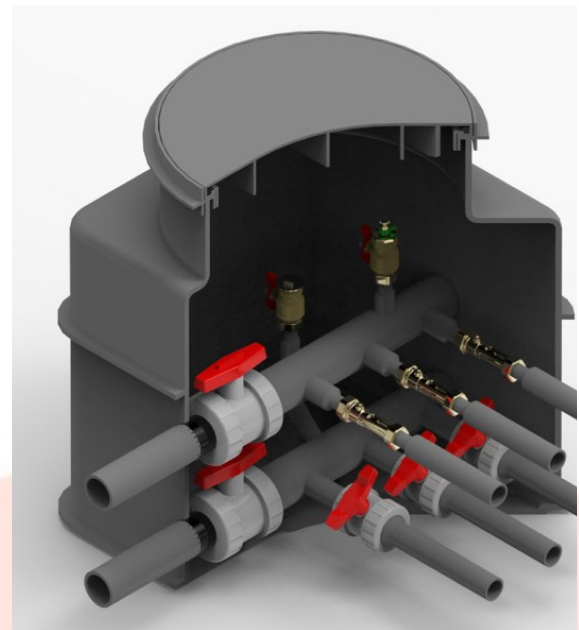

DC3 Manifold

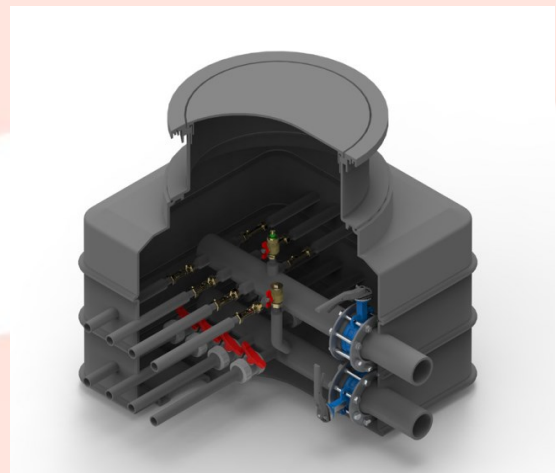

DC4 Manifold

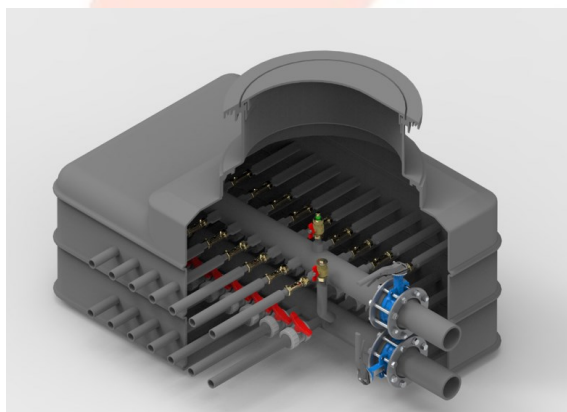

DC5 Manifold



## Underground Manifold Chambers

### DC3 Manifold Chamber

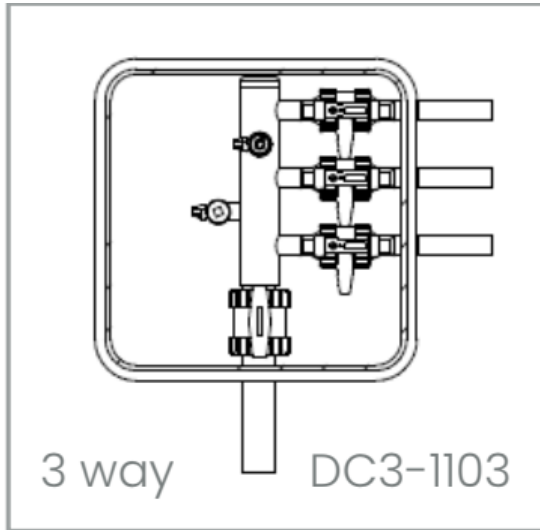

Supplied with the correct number of 40-32mm electrofusion reducers.

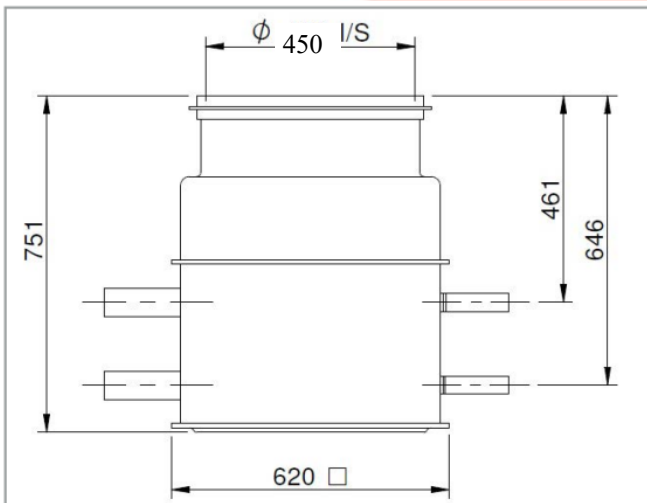

Material	Polyethylene (PE100)
Approx Inside dims	560mm x 560mm
Height (dependant on inlet/outlets)	751mm
Depth to first inlet (frost protection)	Approx 461mm
Depth to first inlet (spade protection)	461mm
Number of inlets & outlets	2,3,4,5,6
Diameter of inlets (Ground array connections)	40mm supplied with 40mm / 32mm Electrofusion reducers.
Diameter of outlets (Heat Pump connections)	63mm Stubs supplied with 2 x 50mm isolation valves
Flowmeter (if option ordered)	8-38 lpm flow meter
Manifold orientation	Horizontal
Weight (dependant on height)	40kG
Internal Isolation valves	2 x DN50 PVC ball valves on heat pump connection

**All buried joints must be electrofusion .**



## Underground Manifold Chambers

### DC4 Manifold Chamber

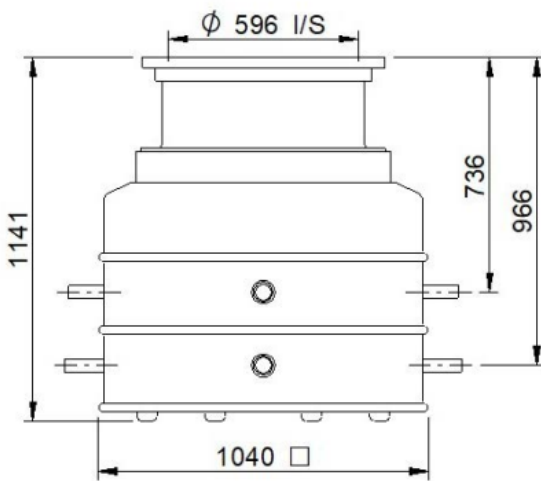
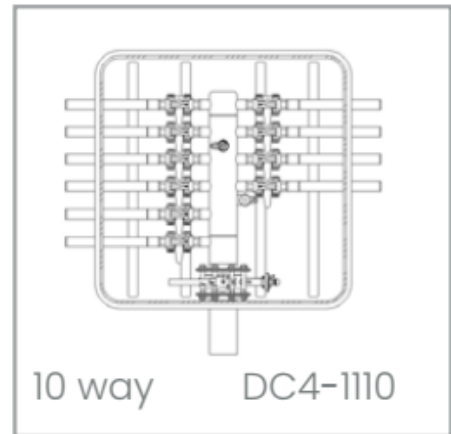
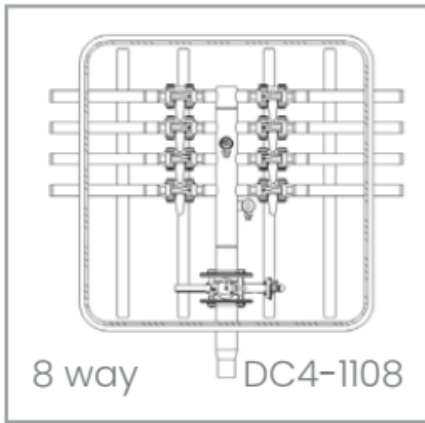

Material	Polyethylene (PE100)
Inside dims	980mm x 980mm
Height (dependant on inlet/outlets)	1130mm
Depth to first inlet (spade protection)	Approx 736m
Number of inlets & outlets	7 up to 10 way
Diameter of inlets	40mm supplied with 40mm / 32mm Electrofusion reducers.
Diameter of outlets	63mm Stubs (7 and 8 way) 110mm Stubs (9—10 way)
Flowmeter (if option ordered)	8-38 lpm flow meter
Manifold orientation	Horizontal
Weight (dependant on height)	N/A
Internal Isolation valves	7 & 8 way DN65 9 & 10 way DN100 butterfly valve

Supplied with the correct number of 40-32mm electrofusion reducers.

**All buried joints must be electrofusion .**



### Underground Manifold Chambers

#### DC5 Manifold Chamber

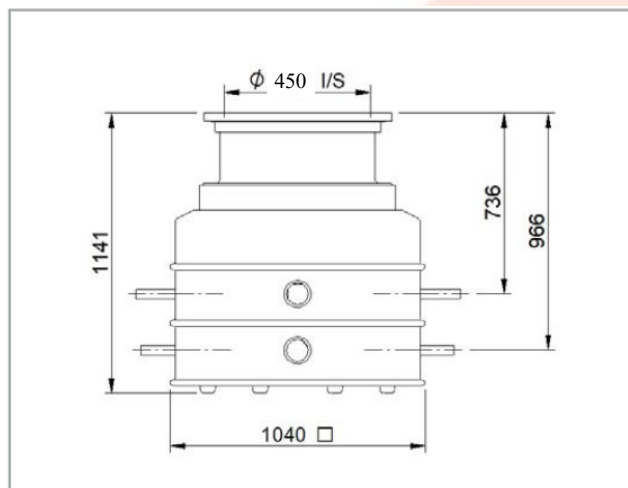
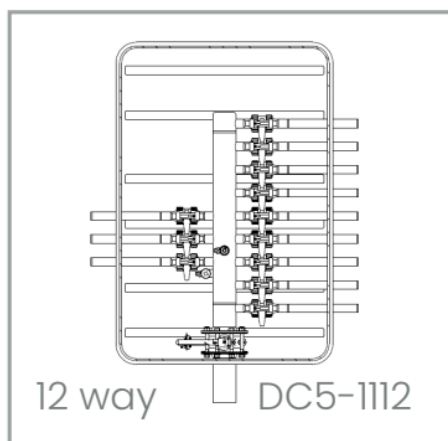

Material	Polyethylene (PE100)
Inside dims	980mm x 1480mm
Height (dependant on inlet/outlets)	1141mm
Depth to first inlet (spade protection)	Approx 736mm
Number of inlets & outlets	12 way
Diameter of inlets	40mm supplied with 40mm / 32mm Electrofusion reducers.
Diameter of outlets	110mm Stubs (12 way)
Flowmeter (if option ordered)	8-38 lpm flow meter
Manifold orientation	Horizontal
Weight (dependant on height)	N/A
Internal Isolation valves	2 x DN100 butterfly valves on heat pump connection

All buried joints must be electrofusion .

Supplied with the correct number of 40-32mm electrofusion reducers.